

Ref. No.	Part No. 零件编号	Description 名称	Q'ty 数量	中文名称
1	DJ160-1-01-01	GUIDE, IN. VALVE (OVER SIZE)...	(1)	进气门导管
2	DJ160-1-01-02	GUIDE, EX. VALVE (OVER SIZE)...	(1)	排气门导管
3	DJ160-1-01	HEAD COMP., CYLINDER.....	1	气缸头组件
5	DJ160-1-08	GASKET, CYLINDER HEAD.....	1	气缸头密封垫
6	DJ160-1-04	COVER COMP., HEAD.....	1	气缸盖组件
7	DJ160-1-06	PACKING, HEAD COVER.....	1	气缸盖密封垫
8	DJ160-1-11	TUBE, BREATHER.....	1	呼吸管
9	DJ160-7-05	GASKET, MUFFLER.....	1	消音器垫圈
10	DJ160-1-07	BOLT, FLANGE, 6X12.....	4	螺栓6×12
11	DJ160-1-02(A)	BOLT, STUD, 6X95.....	2	双头螺栓6×95(机用)
	DJ160-1-02	BOLT, STUD, 6X112.....	2	双头螺栓6×112
12	DJ160-1-03	BOLT, STUD, 8X32.....	2	双头螺栓8×32
13	DJ160-1-09	PIN, DOWEL, 10X16.....	2	定位销10×16
14	DJ160-1-05	BOLT, FLANGE, 8X60.....	4	螺栓8×60
15	DJ160-1-10	PLUG, SPARK (BPR5ES NGK).....	1	火花塞

Cylinder block 气缸体

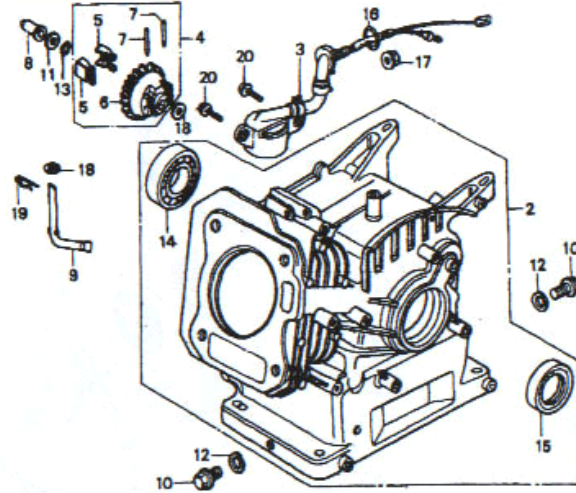

Ref. No.	Part No. 零件编号	Description 名称	Q'ty 数量	中文名称
2	DJ160-2-01	BARREL ASSY., CYLINDER.....	1	气缸套总成(机油泵报)(含5-01)
3	DJ160-2-06	SWITCH ASSY., OIL LEVEL.....	1	机油油位开关总成
4	DJ160-5-02	GOVERNOR ASSY.....	1	调速器总成
5	DJ160-5-02-01	WEIGHT, GOVERNOR.....	2	调速离心块
6	DJ160-5-02-01	HOLDER, GOVERNOR. WEIGHT....	1	调速离心块支架
7	DJ160-5-02-02	PIN, GOVERNOR WEIGHT.....	2	调速离心块销钉
8	DJ160-5-03	SLIDER, GOVERNOR.....	1	调速滑块
9	DJ160-5-06	SHAFT, GOVERNOR ARM.....	1	调速臂轴
10	DJ160-2-02	BOLT, DRAIN PLUG.....	2	泄油螺栓
11	DJ160-5-04	WASHER, THRUST, 6MM.....	1	助推垫片6mm
12	DJ160-2-03	WASHER, DRAIN PLUG, 10.2MM...	2	泄油垫片10.2mm
13	DJ160-5-05	CLIP, GOVERNOR HOLDER.....	1	调速托架卡簧
14	DJ160-2-04	BEARING, RADIAL BALL (6205)....	1	滚珠轴承(6205)
15	DJ160-2-05	OIL SEAL, 25×41×6.....	1	油封25×41×6
16	DJ160-2-07	O-RING, 14MM (NOK).....	1	O形圈14mm(NOK)
17	DJ160-2-08	NUT, FLANGE, 10MM.....	1	螺母10mm
18	DJ160-5-08	WASHER, PLAIN, 6MM.....	2	垫片6mm
19	DJ160-5-07	PIN, LOCK, 8MM.....	1	锁销8mm
20	DJ160-2-09	BOLT, FLANGE, 6×12.....	2	螺栓6×12

Crankcase cover 曲轴箱盖

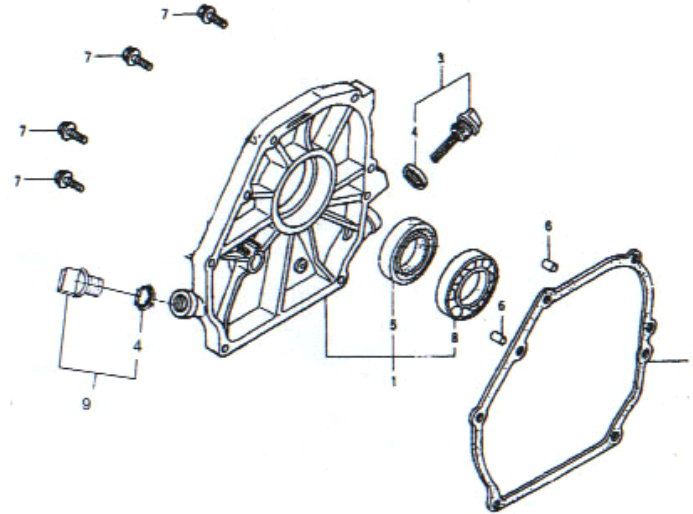

Ref. No.	Part No. 零件编号	Description 名称	Qty 数量	中文名称
1	DJ160-3-01	COVER ASSY., CRANKCASE.....	1	曲轴箱盖总成
2	DJ160-3-02	PACKING, CASE COVER (NON ASBEST)	1	曲轴箱盖垫圈(NON ASBEST)
3	DJ160-3-03	CAP ASSY., OIL FILLER.....	1	机油尺总成
4	DJ160-3-05	PACKING, OIL FILLER CAP.....	2	机油塞垫圈
5	DJ160-3-06	OIL SEAL, 25×41×6.....	1	油封25×41×6
6	DJ160-3-07	PIN, DOWEL, 8×14.....	2	定位销8×14
7	DJ160-3-09	BOLT, FLANGE, 8×32.....	6	螺栓8×32
8	DJ160-3-08	BEARING, RADIAL BALL, 6205.....	1	滚珠轴承6205
9	DJ160-3-04	CAP ASSY., OIL PLUP.....	1	机油塞总成

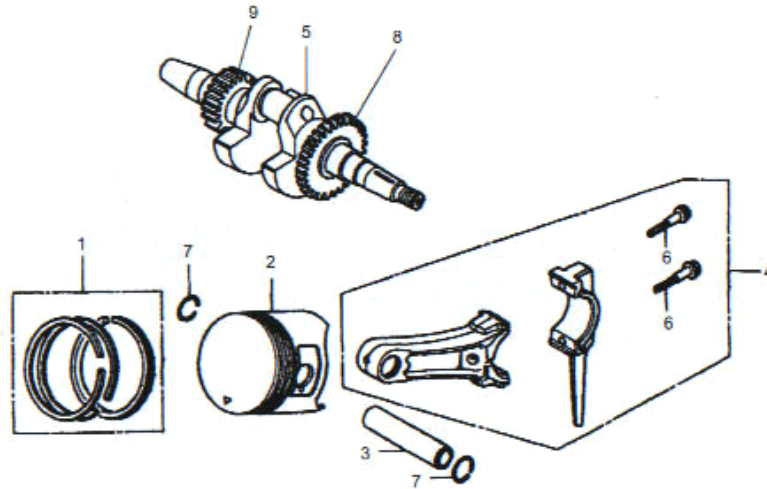

Ref. No.	Part No. 零件编号	Description 名称	Q'ty 数量	中文名称
1	DJ160-4-01	RING SET, PISTON (STD.).....	1	活塞环(标准)
		RING SET, PISTON (0.25).....	(1)	活塞环(0.25)
		RING SET, PISTON (0.50).....	(1)	活塞环(0.50)
		RING SET, PISTON (0.75).....	(1)	活塞环(0.75)
2	DJ160-4-02	PISTON (STD.).....	1	活塞环(标准)
		PISTON (0.25).....	(1)	活塞环(0.25)
		PISTON (0.50).....	(1)	活塞环(0.50)
		PISTON (0.75).....	(1)	活塞环(0.75)
3	DJ160-4-04	PIN, PISTON.....	1	活塞销
4	DJ160-4-03	ROD ASSY., CONNECTING (STD.)...	1	连杆总成(标准)
5	DJ160-4-06	CRANKSHAFT COMP.....	1	曲轴
6	DJ160-4-03-01	BOLT, CONNECTING ROD.....	2	连杆螺栓
7	DJ160-4-05	CLIP, PISTON PIN, 18MM.....	2	活塞销卡簧18mm
8	DJ160-4-08	GEAR, GOVERNOR DRIVE.....	1	调速传动齿轮
9	DJ160-4-07	GEAR, TIME.....	1	正时齿轮

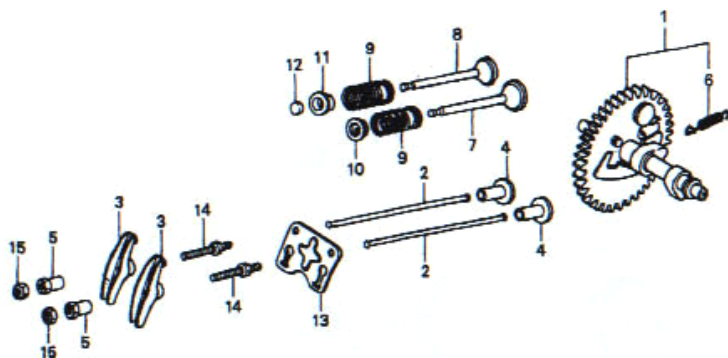

Ref. No.	Part No. 零件编号	Description 名称	Q'ty 数量	中文名称
1	DJ160-4-09	CAMSHAFT ASSY.....	1	凸轮轴总成
2	DJ160-1-12	ROD, PUSH.....	2	推杆
3	DJ160-1-13	ARM, VALVE ROCHER.....	2	气门摇臂
4	DJ160-1-14	LIFTER, VALVE.....	2	气门挺杆
5	DJ160-1-15	PIVOT, ADJUST NUT.....	2	摇臂调整螺母
6	DJ160-4-09-01	SPRING, WEIGHT RETURN.....	1	离心块复位弹簧
7	DJ160-1-16	VALVE, IN.....	1	进气阀
8	DJ160-1-17	VALVE, EX.....	1	排气阀
9	DJ160-1-18	SPRING, VALVE.....	2	气门弹簧
10	DJ160-1-19	RETAINER, IN. VALVE SPRING....	1	进气门弹簧座
11	DJ160-1-20	RETAINER, EX. VALVE SPRING....	1	排气门弹簧座
12	DJ160-1-21	ROTATOR, VALVE.....	1	气门转子
13	DJ160-1-22	PLATE, PUSH ROD GUIDE.....	1	推杆导板
14	DJ160-1-23	BOLT, PIVOT (8MM).....	2	摇臂轴螺栓(8mm)
15	DJ160-1-24	NUT, PIVOT LOCK.....	2	锁紧螺母

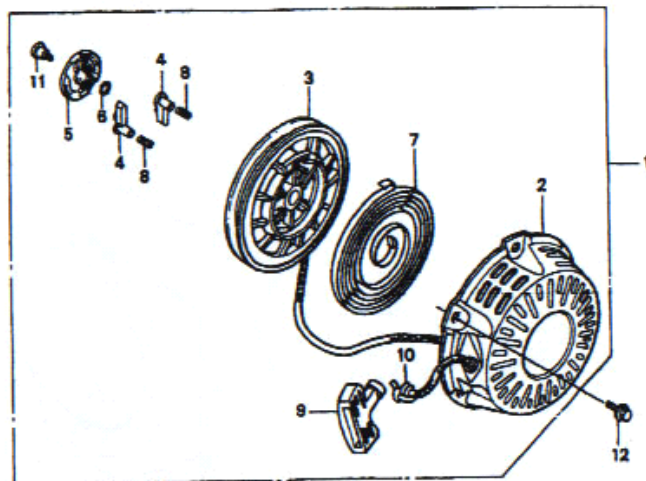

Ref. No.	Part No. 零件编号	Description 名称	Q'ty 数量	中文名称
1	DJ160-10-01	STARTER ASSY., RECOIL.....	1	反冲起动器总成
2	DJ160-10-01-01	CASE COMP., RECOIL STARTER..	1	反冲起动器盖组件
3	DJ160-10-01-02	REEL, RECOIL STARTER.....	1	卷轮
4	DJ160-10-01-03	RATCHET, STARTER.....	2	棘爪
5	DJ160-10-01-11	GUEDE, RATCHET.....	1	棘爪导板
6	DJ160-10-01-04	SPRING, RFICTION.....	1	阻尼弹簧
7	DJ160-10-01-05	SPRING, RECOIL STARTER.....	1	起动器弹簧
8	DJ160-10-01-06	SPRING, RETURN.....	2	复位弹簧
9	DJ160-10-01-07	KNOB, RECOIL STARTER.....	1	手把
10	DJ160-10-01-08	ROPE, RECOIL STARTER.....	1	拉绳
11	DJ160-10-01-09	SCREW, SETTING.....	1	紧固螺钉
12	DJ160-10-01-10	BOLT, FLANGE, 6×8.....	3	螺栓 6×8

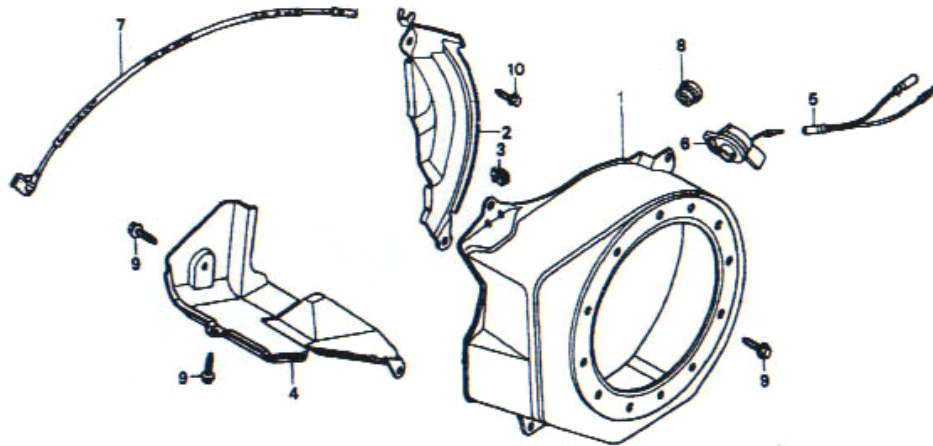

Ref. No.	Part No. 零件编号	Description 名称	Q'ty 数量	中文名称
1	DJ160-10-02	COVER COMP., FAN.....	1	风扇盖组件(导风罩)
2	DJ160-10-03	PLATE, SIDE (OIL ALERT).....	1	边罩(机油警告)
3	DJ160-10-03-01	CLAMPER, CORD.....	1	高压电缆夹
4	DJ160-10-04	SHROUD COMP.....	1	下护罩
5	DJ160-10-06	SUB HARNESS.....	1	插件
6	DJ160-10-05	SWITCH ASSY., ENGINE STOP..	1	发动机停机开关
7	DJ160-8-05-02	CORD, STOP SWITCH (370MM)..	1	停机电缆(370mm)
8	DJ160-10-05A	RUBBER PLUG.....	1	堵孔橡胶圈(带面板机组用)
9	DJ160-10-07	BOLT, FLANGE, 6 × 12.....	6	螺栓 6 × 12.
10	DJ160-10-08	BOLT, FLANGE, 6 × 20.....	1	螺栓 6 × 20.

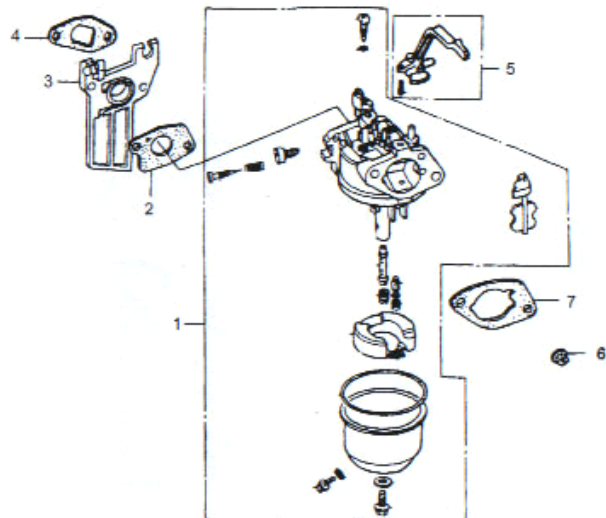

Ref. No.	Part No. 零件编号	Description 名称	Q'ty 数量	中文名称
1	DJ160-6-01(A)	CARBURETOR ASSY.....	1	化油器总成(用于带大油箱机组)
2	DJ160-6-04	PACRING, CARBURETOR.....	1	化油器密封垫
3	DJ160-6-03	INSULATOR, CARBURETOR...	1	化油器绝缘子
4	DJ160-6-02	PACKING INSULATOR.....	1	绝缘子垫圈
5	DJ160-6-01(A)-01	LEVER COMP., CHOKE.....	1	阻风门调节杆
6	DJ160-6-06-09	NUT M6.....	2	螺母
7	DJ160-6-05	PACHING, AIR, CLEANER.....	1	空气滤清器垫片

Carburetor 化油器

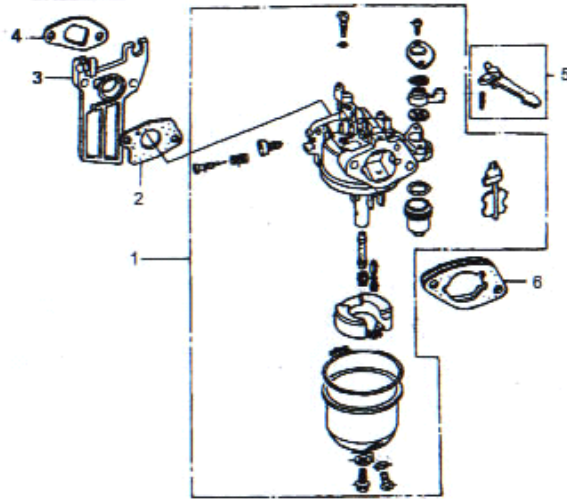

Ref. No.	Part No. 零件编号	Description 名称	Q'ty 数量	中文名称
1	DJ160-6-01	CARBURETOR ASSY.....	1	化油器总成(用于小油箱(简易)机组)
2	DJ160-6-04	PACKING CARBURETOR.....	1	化油器密封垫
3	DJ160-6-03	INSULATOR, CARBURETOR...	1	化油器绝缘子
4	DJ160-6-02	PACKING INSULATOR.....	1	绝缘子垫圈
5	DJ160-6-01-01	LEVER COMP CHOKE.....	1	阻风门调节杆
6	DJ160-6-05	PACKING, AIR CLEANER.....	1	空气滤清器垫片

Air cleaner 空气滤清器

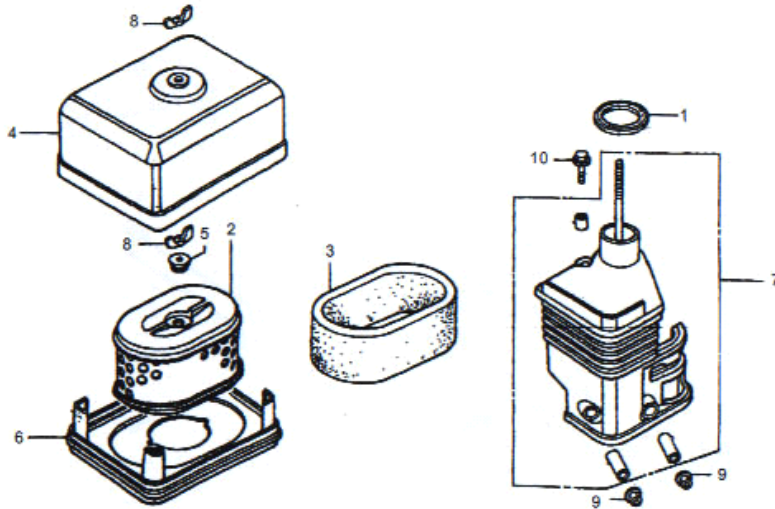

Ref. No.	Part No. 零件编号	Description 名称	Q'ty 数量	中文名称
1	DJ160-6-06-02	PACKING, ELBOW.....	1	空气滤清器座垫圈
2	DJ160-6-06-03	ELEMENT, AIR CLEANER (DUAL)...	1	空气滤清器滤芯(对偶式)
3	DJ160-6-06-04	FILTER, OUTER.....	1	外过滤棉
4	DJ160-6-06-05	COVER, AIR CLEANER (DUAL).....	1	空气滤清器外罩(对偶式)
5	DJ160-6-06-06	GROMMET, AIR CLEANER.....	1	空气滤清器橡胶圈
6	DJ160-6-06-07	NOSE, SILENCER.....	1	消音板
7	DJ160-6-06-01	ELBOW COMP., AIR CLEANER.....	1	空气滤清器座
8	DJ160-6-06-08	NUT, TOOL BOX SETTING.....	2	蝴蝶螺母
9	DJ160-6-06-09	NUT, FLANGE, 6MM.....	2	螺母 6mm.
10	DJ160-6-06-10	BOLT, FLANGE, 6×20.....	1	螺栓 6×20.

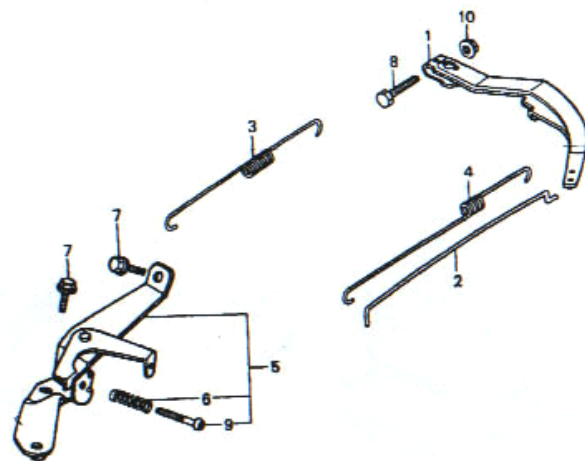

Ref. No.	Part No. 零件编号	Description 名称	Q'ty 数量	中文名称
1	DJ160-5-09	ARM, GOVERNOR.....	1	调速臂
2	DJ160-5-10	ROD, GOVERNOR.....	1	调速拉杆
3	DJ160-5-11	SPRING, GOVERNOR.....	1	调速弹簧
4	DJ160-5-12	SPRING, THROTTLE RETURN.....	1	节气门复位弹簧
5	DJ160-5-13	CONTROL ASSY.....	1	调速底座总成(2500CL)
6	DJ160-5-13-01	SPRING, CONTROL ADJUSTING.....	1	控制调节弹簧
7	DJ160-5-13-02	BOLT, FLANGE, 6×12.....	2	螺栓6×12
8	DJ160-5-14	BOLT, GOVERNOR ARM.....	1	调速臂螺栓
9	DJ160-5-13-03	SCREW, PAN, 5×35.....	1	螺钉5×35.
10	DJ160-5-15	NUT, FLANGE, 6MM.....	1	螺母6mm

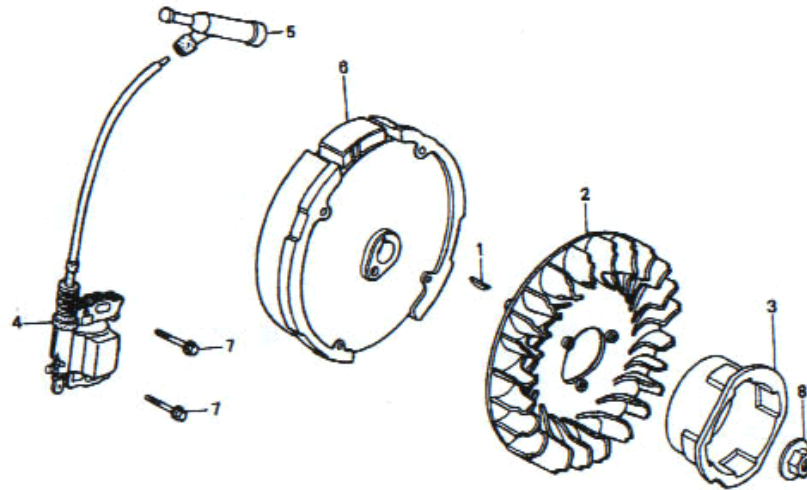

Ref. No.	Part No. 零件编号	Description 名称	Q'ty 数量	中文名称
1	DJ160-8-02	KEY, SPECIAL WOODRUFF, 4×6.5×25.....	1	半圆键4×6.5×25
2	DJ160-8-03	FAN, COOLING.....	1	冷却风扇
3	DJ160-8-04	PULLEY, STARTER.....	1	起动机拉轮
4	DJ160-8-05	COIL ASSY., IGNITION.....	1	点火线圈总成
5	DJ160-8-05-01	CAP ASSY., NOISE SUPPRESSOR.....	1	火花塞帽
6	DJ160-8-01	FLYWHEEL COMP.....	1	飞轮组件
7	DJ160-8-06	BOLT, FLANGE, 6×25.....	2	螺栓6×25
8	DJ160-8-07	NUT, SPECIAL, 14MM.....	1	螺母14mm

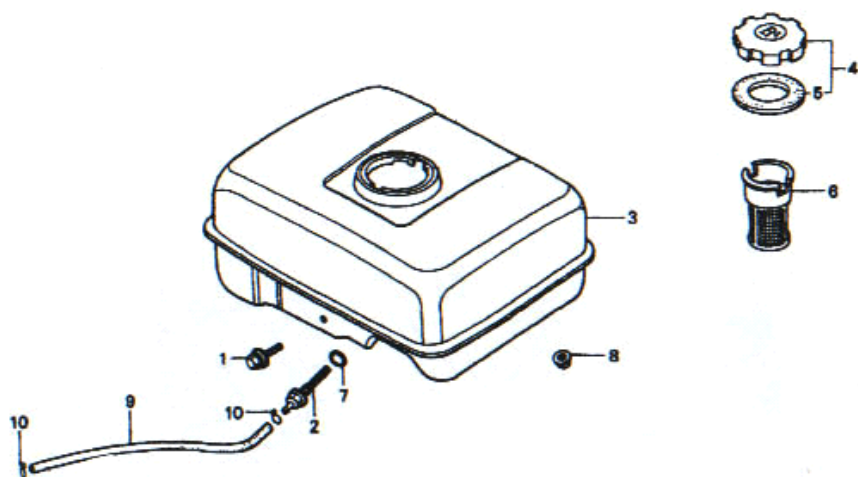

Ref. No.	Part No. 零件编号	Description 名称	Q'ty 数量	中文名称
1	DJ160-9-09	BOLT, FLANGE 6×25.....	1	螺栓 6×25
2	DJ160-9-04	JOINT, FUEL TANK.....	1	燃油箱接头
3	DJ160-9-01	TANK COMP., FUEL.....	1	燃油箱组件
4	DJ160-9-02	CAP COMP., FUEL FILLER.....	1	燃油箱盖
5	DJ160-9-03	PACKING, FUEL FILLER CAP.....	1	燃油箱盖垫圈
6	DJ160-9-06	FILTER, FUEL.....	1	燃油滤网
7	DJ160-9-05	O-RING, 14MM (NOK).....	1	O形圈 14mm(NOK)
8	DJ160-9-10	NUT, FLANGE, 6MM.....	2	螺母 6mm
9	DJ160-9-07	TUBE, FUEL, 4.5×140.....	1	燃油管 4.5×140
10	DJ160-9-08	CLIP, TUBE (B8).....	2	管夹 (B8) (卡箍)

Muffler 消音器

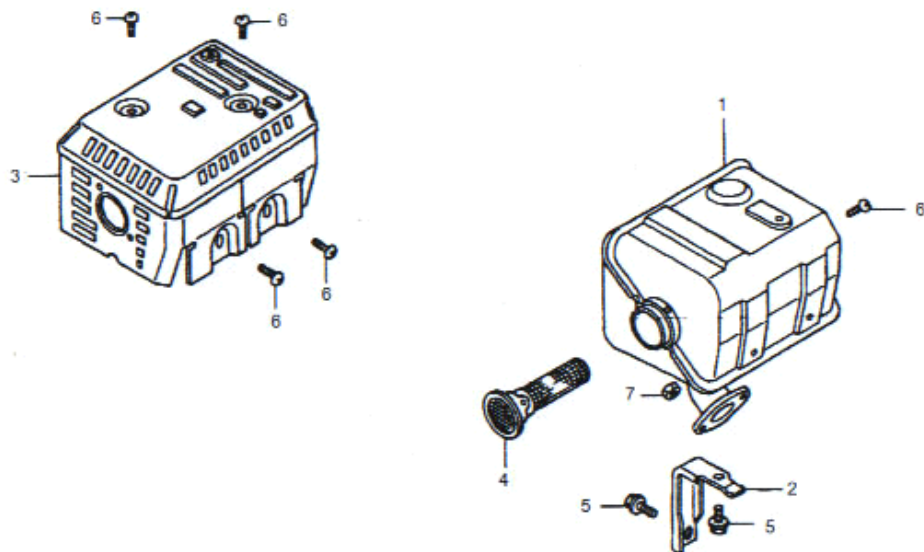

Ref. No.	Part No. 零件编号	Description 名称	Q'ty 数量	中文名称
1	DJ160-7-01	MUFFLER COMP. (SILENT).....	1	消音器组件
2	DJ160-7-02	STAY, MUFFLER.....	1	消音器支架
3	DJ160-7-01-01	PROTECTOR, MUFFLER (SILENT)...	1	消音器保护罩
4	DJ160-7-01-02	ARRESTER, SPARK (SILENT).....	1	火花消除器
5	DJ160-7-03	BOLT, FLANGE, 6×12.....	2	螺栓 6×12
6	DJ160-7-01-03	SCREW, TAPPING, 5×8.....	5	螺钉 5×8
7	DJ160-7-04	NUT, HEX., 8MM.....	2	螺母 8mm